

Borga Z-profiles

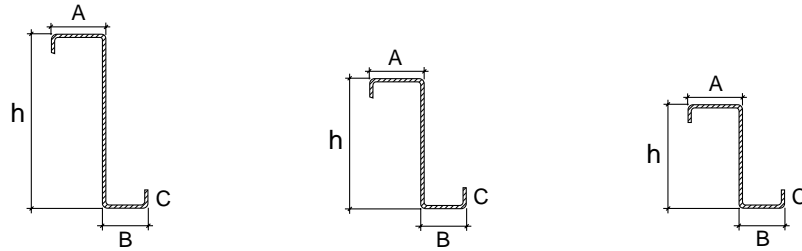

Borga Z-profiles are usually used as wall girts and roof purlins. Z-purlins are specially designed for overlap and continuous installation, where the strength of the double section is used in the engineering process to lower the total weight of the construction. Automatic hole punching unit in the production line enables offering high quality Z-profiles with prepunched holes as an option. Prepunched holes gives precise and quick assembly.

Material:

The raw material is delivered to our production plant in coils with thickness from 1,2 to 2,5 mm. All cold-formed profiles are made from high quality steel, 350 Mpa, covered on both sides by zink layer equal to 275 g/m². The width of the coils varies from 1000 mm to 1250 mm. Prior to production the coils are slitted into the exact width needed for given profile.

Z - profiles - Technical parameters

Profile	Z 120x1,2	Z 120x1,5	Z 120x2,0	Z 120x2,5	Z 150x1,2	Z 150x1,5	Z 150x2,0	Z 150x2,5	Z 200x1,2	Z 200x1,5	Z 200x2,0	Z 200x2,5
Height h [mm]	120	120	120	120	150	150	150	150	200	200	200	200
Thickness t [mm]	1,17	1,42	1,91	2,40	1,17	1,42	1,91	2,40	1,17	1,42	1,91	2,40
A [mm]	59,0	59,0	59,0	59,0	59,0	59,0	59,0	59,0	59,0	59,0	59,0	59,0
B [mm]	52,0	52,0	52,0	52,0	52,0	52,0	52,0	52,0	52,0	52,0	52,0	52,0
C [mm]	14,0	15,0	18,0	20,0	14,0	15,0	18,0	20,0	14,0	15,0	18,0	20,0
Slit s [mm]	243	243	243	243	273	273	273	273	323	323	323	323
Zink layer [g/m ²]	275	275	275	275	275	275	275	275	275	275	275	275
Ag [cm ²]	2,88	3,51	4,73	5,93	3,23	3,94	5,30	6,65	3,77	4,59	6,18	7,75
Weight g [kg/m]	2,37	2,84	3,78	4,71	2,66	3,19	4,24	5,29	3,14	3,78	5,02	6,26
Ig [cm ⁴]	66,6	80,6	106,0	131,4	111,7	135,4	179,0	222,5	216,4	262,7	349,7	436,0
Vr [kN]	12,19	17,96	28,52	35,84	11,48	17,96	32,49	44,80	8,61	15,39	32,49	51,30
(Ix) red [cm ⁴]	63,5	80,6	106,0	131,4	105,0	134,0	179,0	222,5	197,3	253,7	345,6	436,0
Wx red [cm ³]	10,46	13,07	17,19	21,31	13,44	17,77	23,29	28,95	18,35	24,51	34,53	42,69
Mr red [kNm]	3,18	3,98	5,23	6,48	4,09	5,41	7,09	8,81	5,59	7,46	10,51	12,99

Parameters according to actual EU norms.

Hole punching

Standard hole punching: Standard hole punching:

- minimal distance from beginning of the Z-profile to the first row of the holes is 25 mm;
- size of the holes: 14 mm x 28 mm, oval
- the holes are punched in pairs, vertically with span of 70 mm;
- the holes are placed symmetrically on the length of the Z-profile;
- one profile can have up to 10 pairs of the holes.

Nonstandard hole punching:

- size of the holes: 14 mm x 28 mm, oval;
- the holes are punched in pairs, vertically with span of 60 or 80 mm;

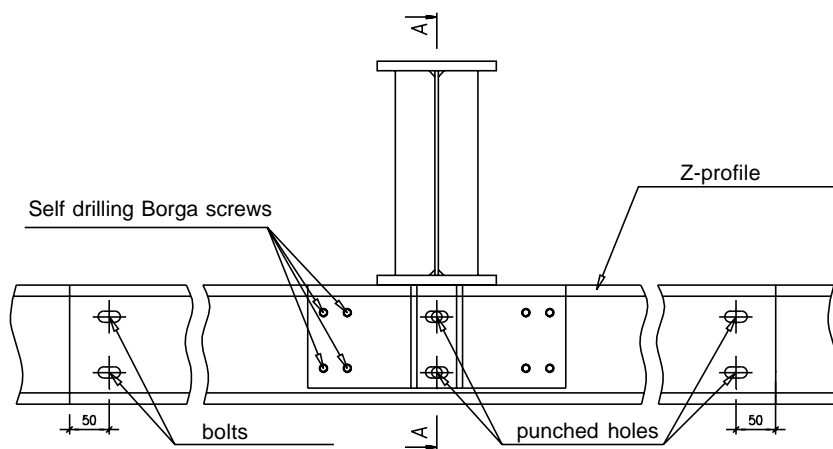

Both for attachment to the construction and overlapping, Borga M12 bolts are recommended to be used.

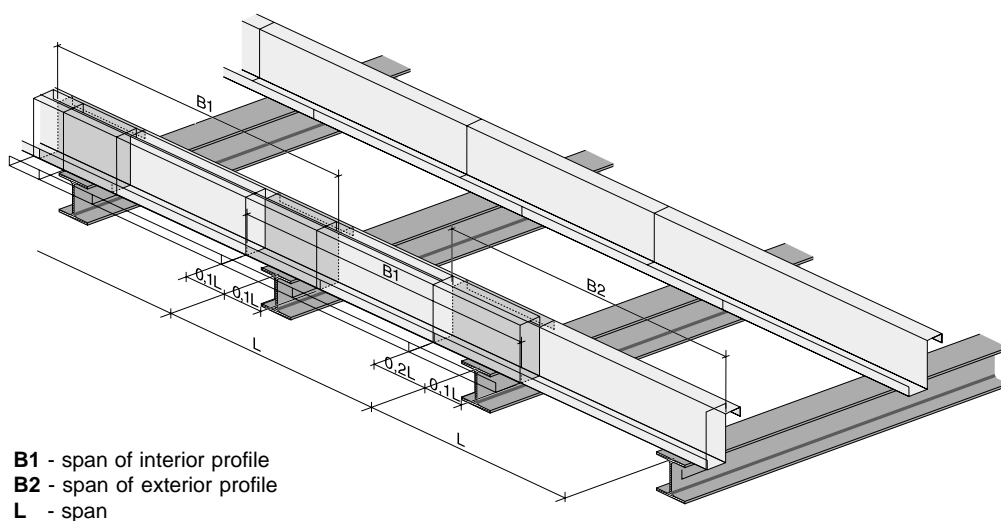

Z-profiles are assembled by overlapping. Every second profile is placed upside down.